

SS 316L Quad Cleat (BICCCQ-Range)



SS 316L Quad Cable Cleat:

In all cable installations, an essential factor is to ensure that all cables are secured with the correct cleats for the cable, application, and environment. The BICCCQ series of cleats support and secure all cables in a quad formation throughout the system during normal operation and during fault conditions that may occur. System integrity is maintained, and cable damage can be prevented.

The BICCCQ range of cleats are designed to meet with requirements to EN 61914:2016 & IEC 61914:2015 standards. The cleats are manufactured from SS316L with excellent durability characteristics, resistant to corrosion and adverse weather conditions. The cleats are designed to hold and retain all types of cables in a Quad formation.

Features:

Material: 316L Stainless steel

Cable Diameter Range: 19mm to 86mm.

Installation: For cables in Quad formation

Short circuit rating: 152kA peak fault

Operating temperature: -60°C to +60°C

Suitable for Use With all Standard Ladder and Tray Systems

Liners are classified as Low Smoke & Fume (LSF)

Zero Halogen (LSOH) and Phosphorus Free

Combined single (M10) or 2 bolt (M10) fixing design

SHORT CIRCUIT TESTING TO IEC 61914 - CLAUSE 9.5	
Two short circuits	Two short circuits
300mm fixed cleat	600mm fixed cleat
Centres	Centres
0.1 sec	0.1 sec
138kA Peak	103kA Peak
62.7kA r.m.s	49.0kA r.m.s

SS 316L Quad Cleat (BICCQ-Range)

BICCQ Cleat Selection Cable						
Quad Part No.	Cable Ø Range (mm)	Dimensions (mm)				
		W	H	D	P	Fixing Hole Ø
						D1
BICCQ16-20	16-20	40	88	60	50	1.5x M10
BICCQ19-23	19-23	46	95	60	50	1.5x M10
BICCQ21-27	21-27	52	101	60	50	1.5x M10
BICCQ26-31	26-31	60	109	60	50	1.5x M10
BICCQ30-34	30-34	67	116	60	50	1.5x M10
BICCQ33-37	33-37	74	123	60	50	1.5x M10
BICCQ36-40	36-40	80	129	60	50	1.5x M10
BICCQ41-45	41-45	90	139	76	50	1.5x M10
BICCQ44-47	44-47	96	144	76	50	1.5x M10
BICCQ46-51	46-51	101	150	76	50	1.5x M10
BICCQ49-53	49-53	106	155	106	50	1.5x M10
BICCQ52-56	52-56	112	161	106	50	1.5x M10
BICCQ55-59	55-59	118	167	106	50	1.5x M10
BICCQ58-62	58-62	124	173	106	50	1.5x M10
BICCQ61-65	61-65	130	179	126	50	1.5x M10
BICCQ64-68	64-68	136	185	126	50	1.5x M10
BICCQ67-71	67-71	142	191	126	50	1.5x M10

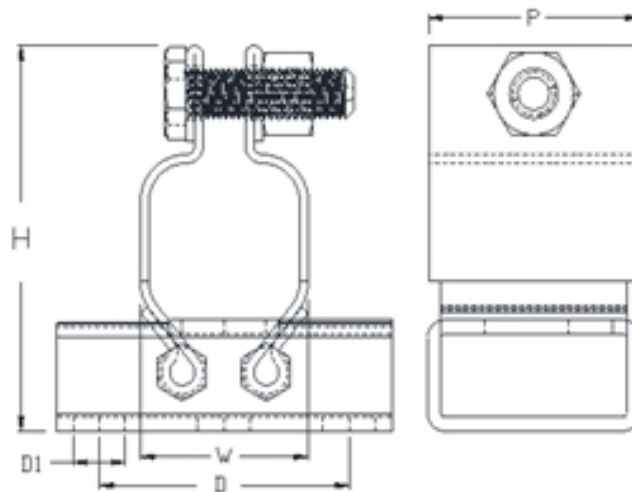

Disclaimer: All dimensions provided in mm, are for guidance and given in good faith, however BICC Components reserve the right to change these without prior notification.